

ASSEMBLING GUIDE
MODEL 9176-9-01

WARNING! NOT SUITABLE FOR CHILDREN
UNDER 3 YEARS. CONTAINS SMALL PARTS.

CAUTION
MATERIAL USED - LAMINATED MEDIUM DENSITY FIBERBOARD AND PARTICLEBOARD FRAME * TO CLEAN
USING SOFT, DRY, CLOTH * DO NOT USE DETERGENT OR CHEMICALS * AVOID CONTACT WITH WATER AND
DIRECT SUNLIGHT * TO BE ASSEMBLED ON A SOFT, DRY, CLEAN AND SMOOTH SURFACE * DO NOT USE
POWER DRILLS TO ASSEMBLE AS THIS MAY CAUSE DAMAGE TO THE PRODUCT IF OVER-TIGHTENED

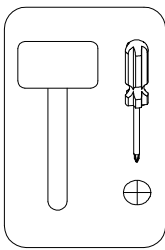
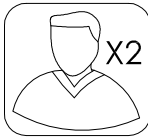
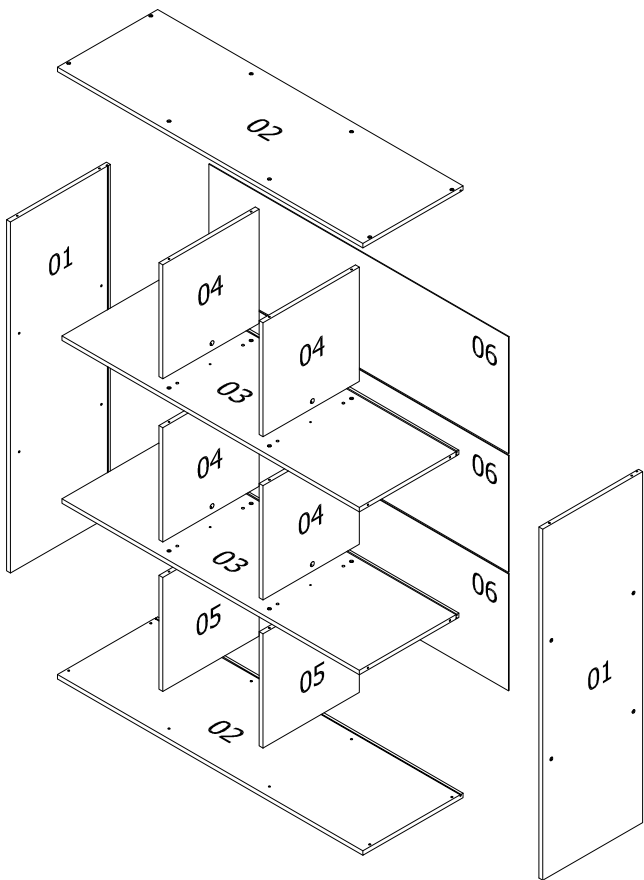

A		CSK SCREW M3.5 X 15MM	12
B		FLAT TOP SCREW M6 X 40	32
C		WOOD DOWEL (Ø8 X 25MM)	8
D		BOLT-9607 PARALEL NECK DOWEL 24 X 8.5	4
E		CAM-9499 CAM 3000 15 X 12	4
F		PLASTIC LEG STUD	6
G		ROUND STICKER (Ø18MM)	20
H		ALLEN KEY M4	1
J		BACKPLY STOPPER	12
K		GLUE	1

1

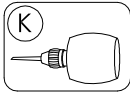
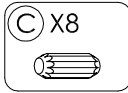
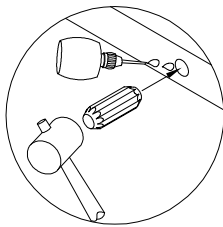
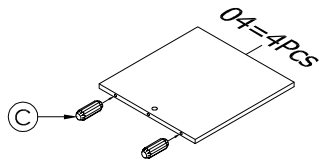

2

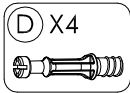
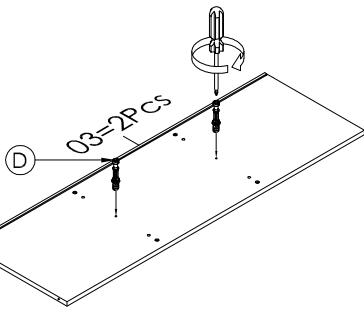

3

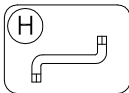
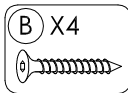
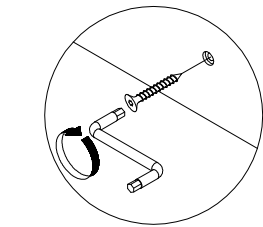
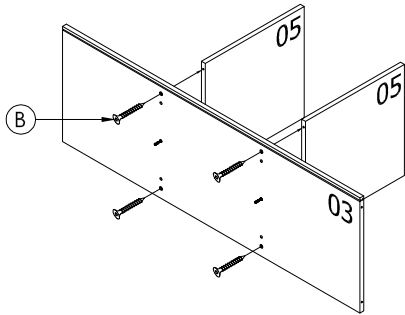

4

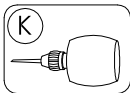
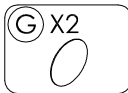
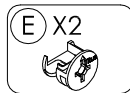
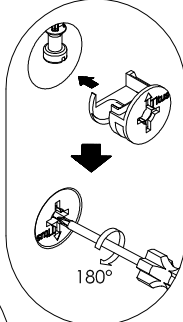
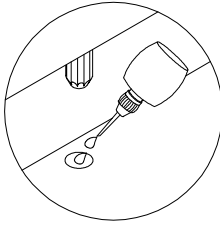
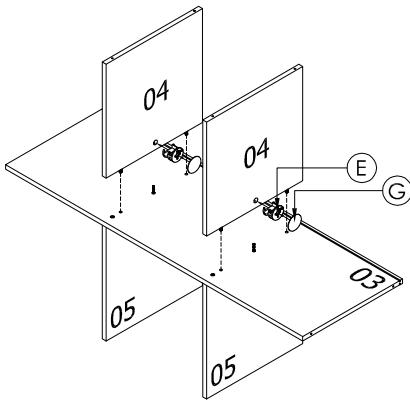

5

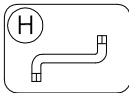
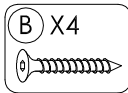
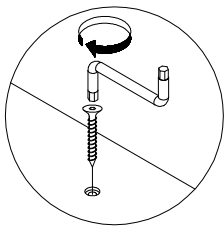
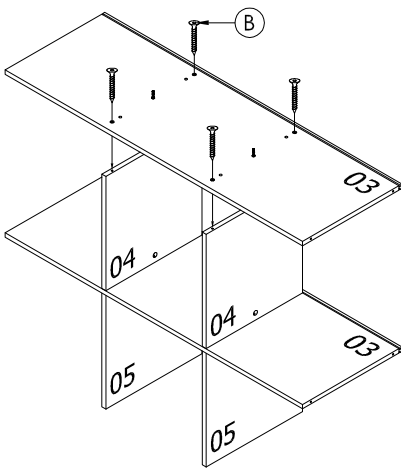

6

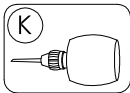
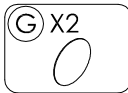
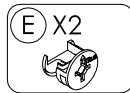
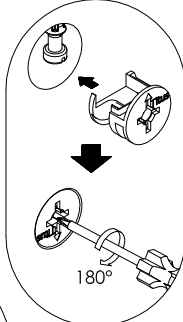
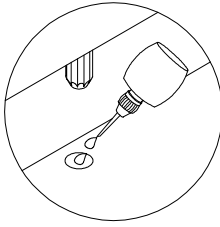
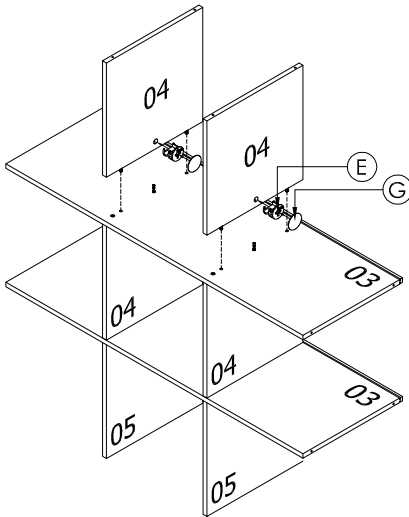

7

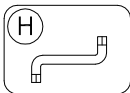
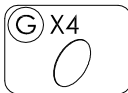
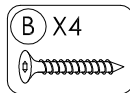
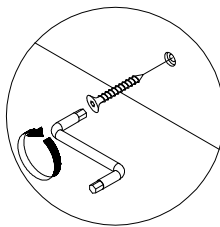
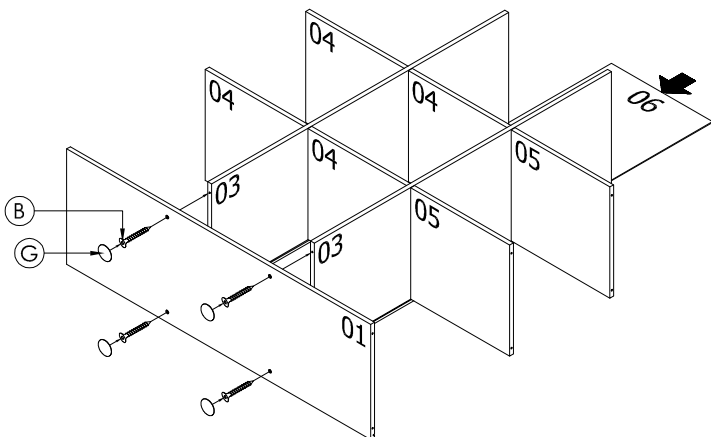

ASSEMBLING GUIDE

MODEL 9176-9-01

WARNING! NOT SUITABLE FOR CHILDREN UNDER 3 YEARS. CONTAINS SMALL PARTS.

CAUTION
MATERIAL USED - LAMINATED MEDIUM DENSITY FIBERBOARD AND PARTICLEBOARD FRAME * TO CLEAN USING SOFT, DRY, CLOTH * DO NOT USE DETERGENT OR CHEMICALS * AVOID CONTACT WITH WATER AND DIRECT SUNLIGHT * TO BE ASSEMBLED ON A SOFT, DRY, CLEAN AND SMOOTH SURFACE * DO NOT USE POWER DRILLS TO ASSEMBLE AS THIS MAY CAUSE DAMAGE TO THE PRODUCT IF OVER-TIGHTENED

8

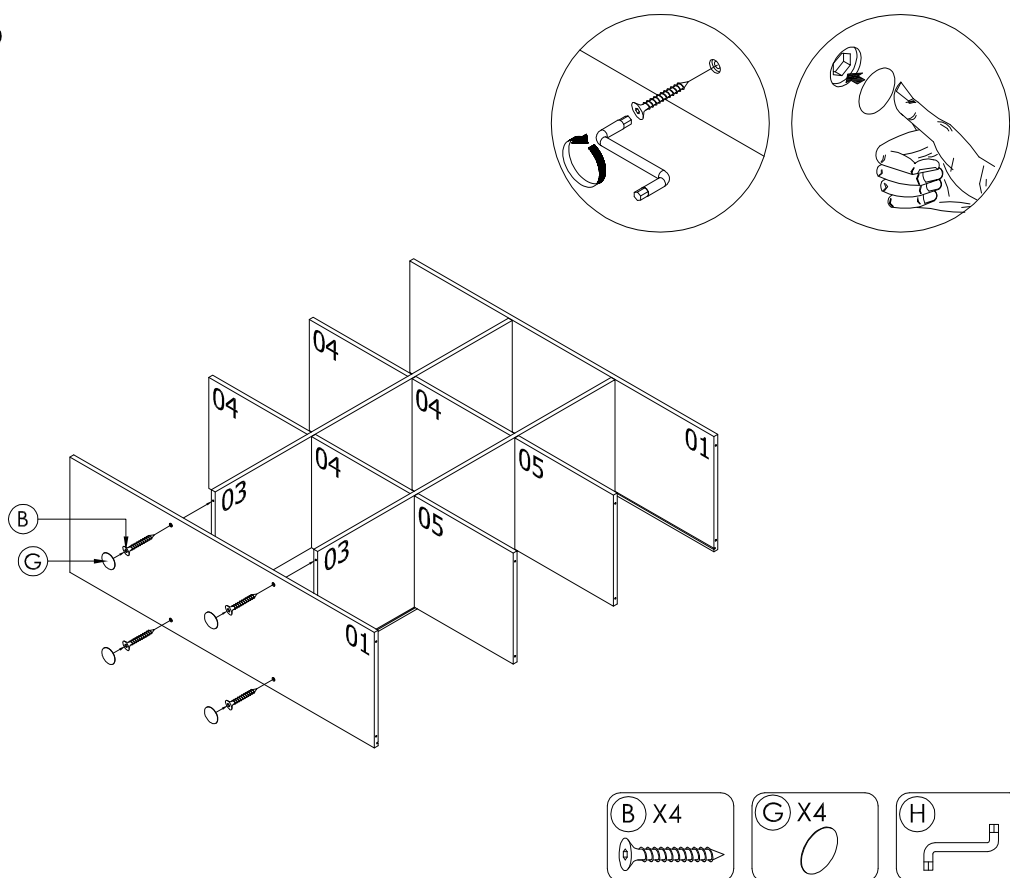

9

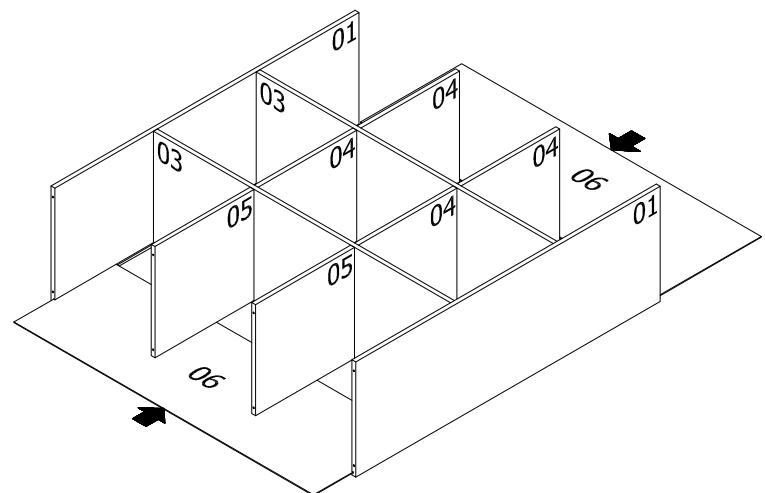

10

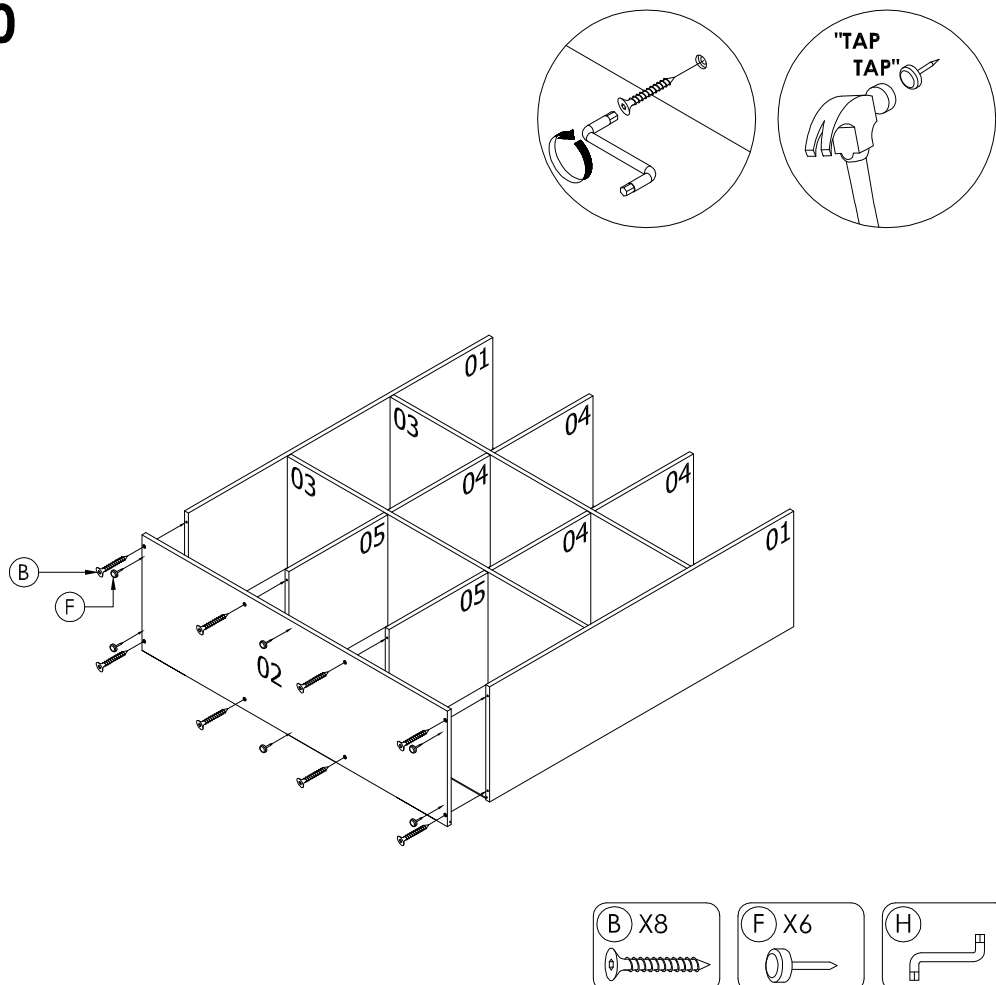

11

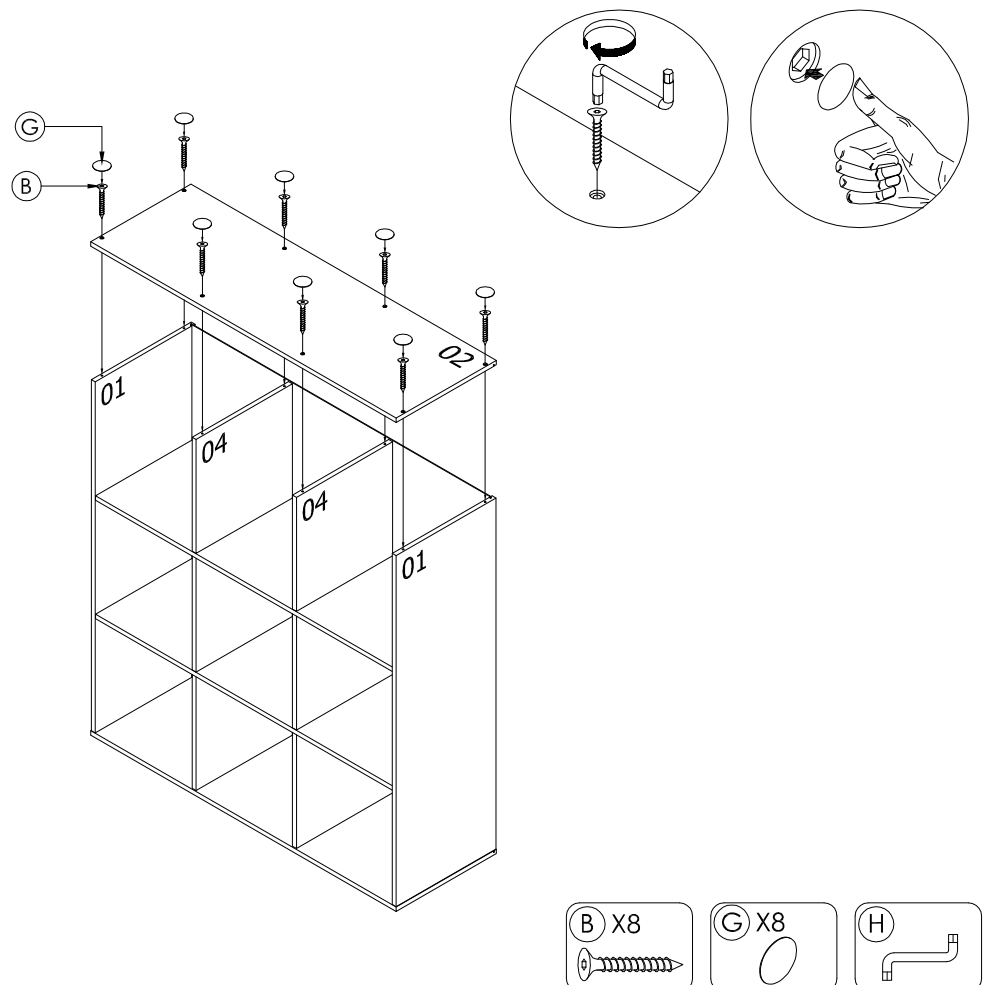

12

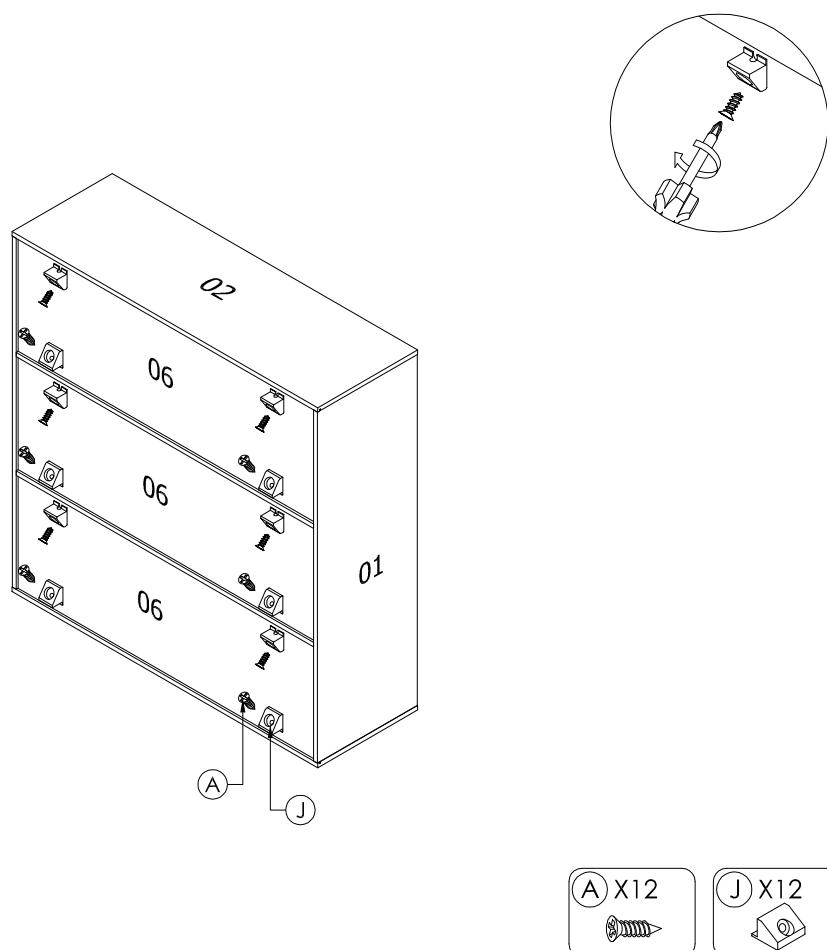

13

